

Note:
 3" steel tube placement varies per framing details, consisting of cross "H" design or "T" configuration. Windows and Door placement varies w/ ea. build, see elevation drawings.

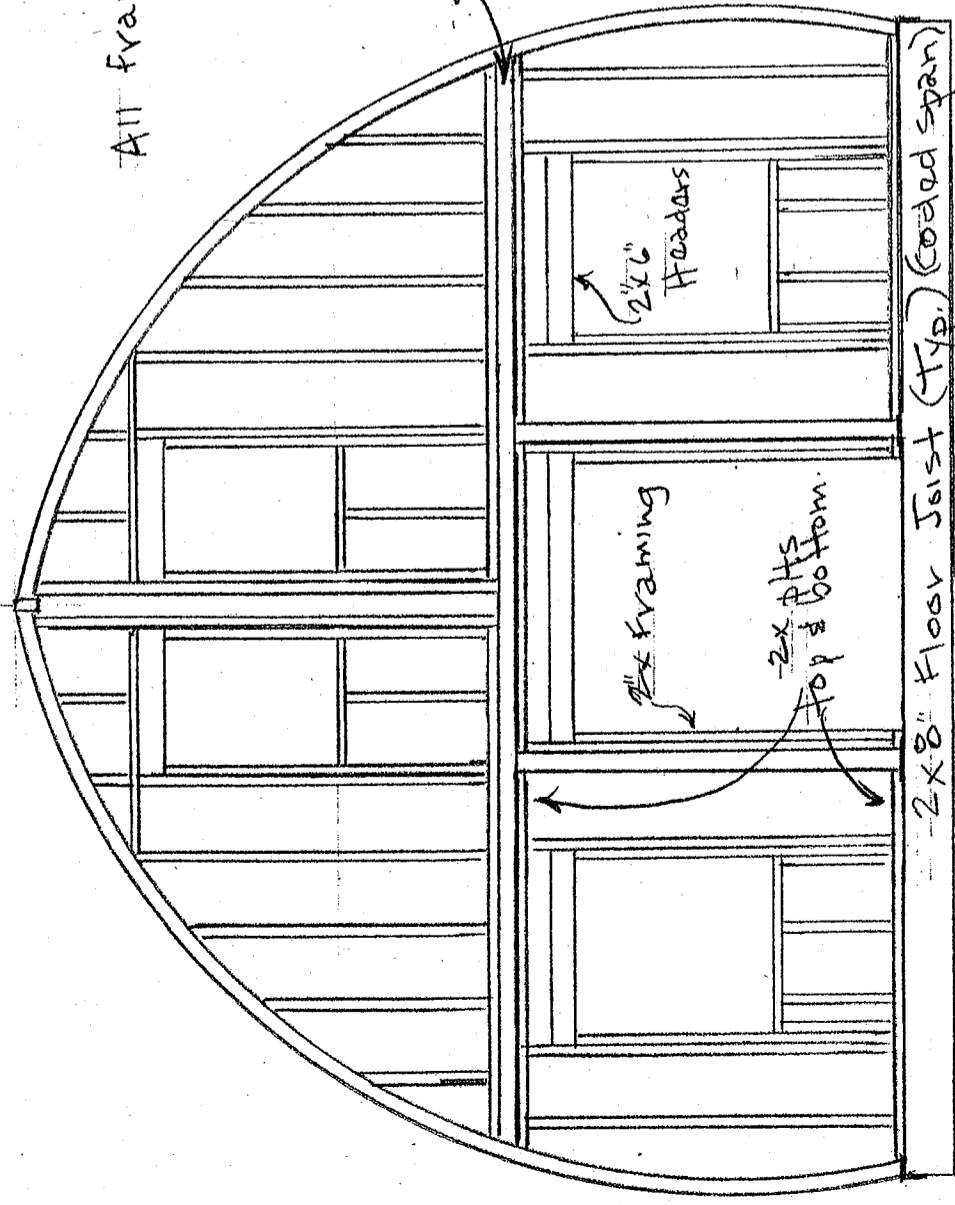

Typ. End Cap Framing Detail

- Notes:
1. 2x4 or 2x6 Framing to comply to local coding. Require permits.
 2. All wood to steel attachment by Tek's 1/4x1/2x1/2" PM 2135B.
 3. All welding performed by certified welder.
 4. Wood to wood attachment by loge x 3" nail. min. 12" o.c., stud to plate 2 nails min.

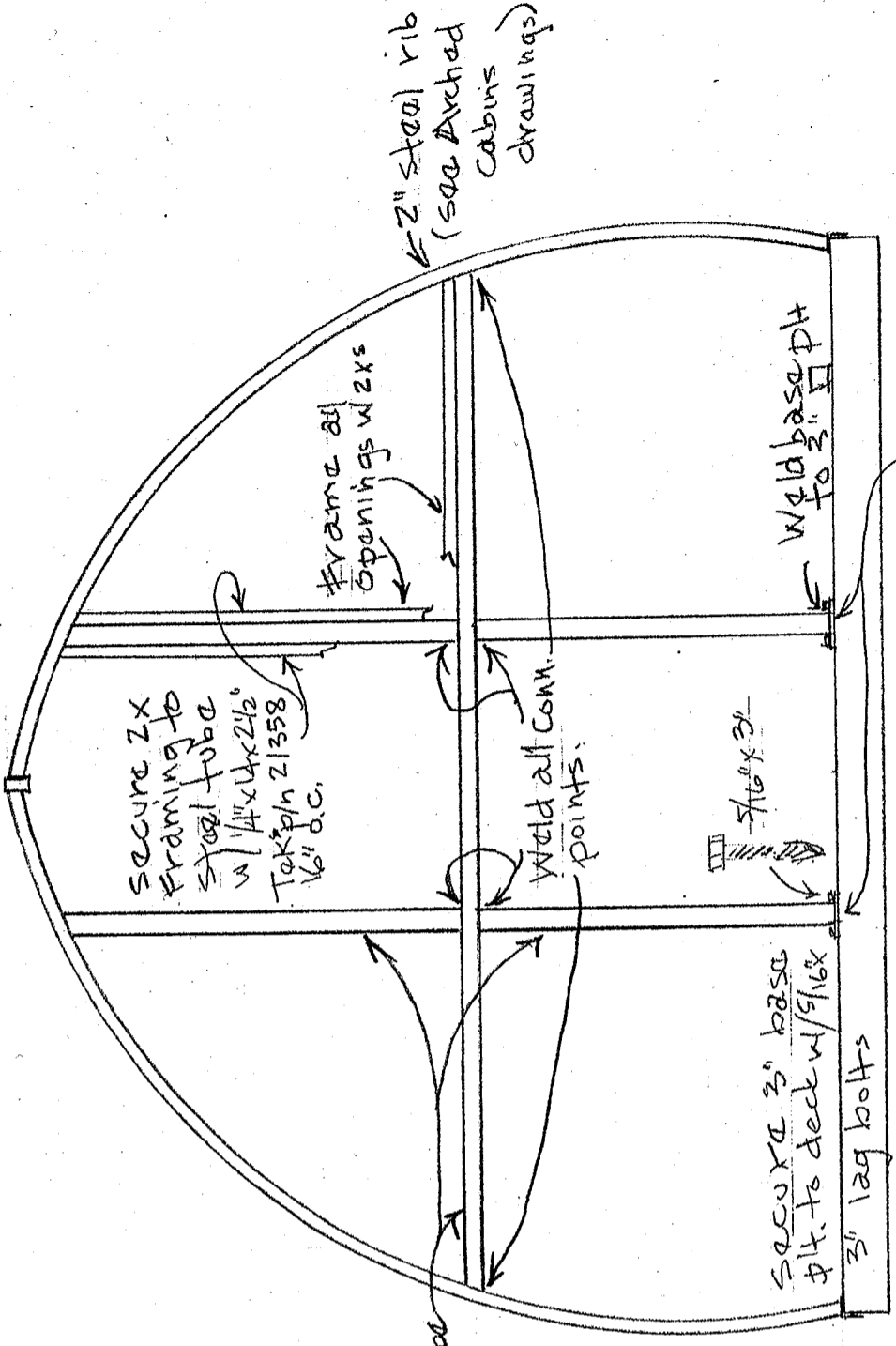

UNLESS OTHERWISE SPECIFIED STANDARD TOLERANCING
 DECIMAL TOLERANCE
 X.X ±1mm
 X.XX ±0.5mm
 X.XXX ±0.10mm
 ANGULAR ±0.5°
 GEOMETRIC TOLERANCING:
 ◎ // ⊥ WITHIN 0.2 T.I.R.
 CAD GENERATED DO NOT MANUALLY UPDATE OR SCALE
 UNITS WEIGHT

ARCHED CABINS
 11834 DIJLA LANE
 CYPRESS, TX 77429
 TEL: (281) 627-3621

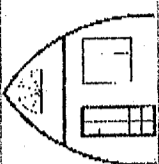

TITLE
 BY DATE
 DRAWN DC 3/17/17
 CHECKED
 APPROVED DC 3/17/17
 MATERIAL
 FINISH

REV.
 DWG. NO. EC003
 SCALE NONE
 SHEET SIZE
 SHEET 1 OF 1

THE INFORMATION CONTAINED IN THIS DRAWING IS CONFIDENTIAL AND PROPRIETARY OF ARCHED CABINS. ANY REPRODUCTION IN PART OR AS A WHOLE WITHOUT WRITTEN PERMISSION OF ARCHED CABINS IS PROHIBITED.